

# EDM<sup>TM</sup> MINIATURE SELF-CLINCHING FASTENERS

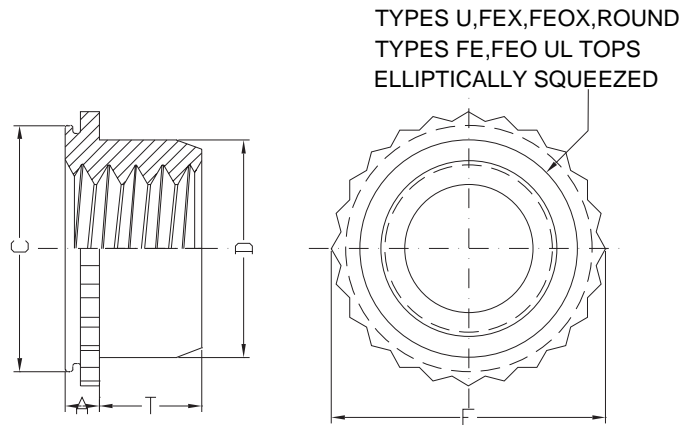

## TYPES EDM-U, EDM-UL, EDM-FE, EDM-FEO, EDM-FEX, EDM-FEOX

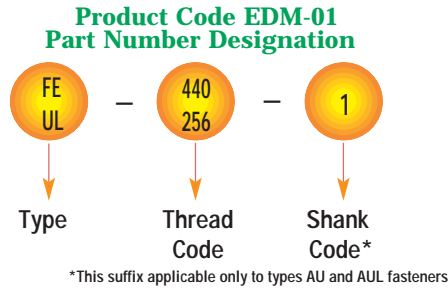

Part No: FEO-M5 Sheet Thickness: 0.99-1.14  
Description Miniature Self-Chinching Fasteners  
Min. Dist. Hole C/L To Edge: 5.200  
Hole Size In Sheet: 7.400 +.08

UNIFIED (Inch)	Thread Size	Type		Thread Code	Shank Code	A Max.	Sheet Thickness (1)	Hole Size In Sheet +.003 -0.000	C +.000 -0.005	D Max.	E ±.005	T +.015 -0.000	Weight Lbs./K	Min. Dist. Hole C/L To Edge	Max. Hole In Attached Parts
		Non-locking(2)	Self-locking												
UNIFIED (Inch)	.060-80 (#0-80)	U	UL	080	0	.020	.019-.022	.110	.1095	.076	.125	.050	.068	.09	.080
	.073-64 (#1-64)	U	UL	164	0	.020	.019-.022	.110	.1095	.090	.125	.050	.070	.09	.093
	.086-56 (#2-56)	U	UL	256	0	.020	.019-.022	.144	.1435	.106	.160	.065	.125	.11	.106
					1	.031	.030-.036						.184		
	.112-40 (#4-40)	FEOX	FEO	440	(4)	.040	.039-.045	.172	.171	.145	.192	.065	.31	.14	.132
		FEX	FE			.060	.059-.070						.37		
	.138-32 (#6-32)	FEOX	FEO	632	(4)	.040	.039-.045	.213	.212	.180	.244	.075	.47	.17	.158
		FEX	FE			.060	.059-.070						.68		
	.164-32 (#8-32)	FEOX	FEO	832	(4)	.040	.039-.045	.290	.289	.215	.322	.090	.98	.20	.184
		FEX	FE			.060	.059-.070						1.24		
	.190-32 (#10-32)	FEOX	FEO	032	(4)	.040	.039-.045	.290	.289	.245	.322	.110	1.04	.20	.210
		FEX	FE			.060	.059-.070						1.20		
1/4-20	FEX	FE	0420	(4)	.060	.059-.070	.344	.343	.318	.384	.120	2.08	.28	.270	
1/4-28			0428									1.58			

METRIC (mm)	Thread Size x Pitch	Type		Thread Code	Shank Code	A Max.	Sheet Thickness (1)	Hole Size In Sheet +0.08	C -0.13	D Max.	E ±0.13	T +0.4	Weight Kg./K	Min. Dist. Hole C/L To Edge	Max. Hole In Attached Parts
		Non-locking(3)	Self-locking												
METRIC (mm)	M2 X 0.4	U	UL	M2	1	0.76	0.76-0.91	3.61	3.6	2.5	4.07	1.65	0.08	2.8	2.5
		FEOX	FEO				1.02						0.99-1.14		
	M3 X 0.5	FEX	FE	M3	(4)	1.53	1.5-1.78	4.39	4.37	3.96	4.88	1.9	0.17	3.6	3.5
		FEOX	FEO				1.02						0.99-1.14		
	M4 X 0.7	FEX	FE	M4	(4)	1.53	1.5-1.78	7.39	7.37	5.23	8.17	2.55	0.54	5.2	4.5
		FEOX	FEO				1.02						0.99-1.14		
	M5 X 0.8	FEX	FE	M5	(4)	1.53	1.5-1.78	7.39	7.37	6.48	8.17	3.05	0.59	5.2	5.5
		FEOX	FEO				1.02						0.99-1.14		
	M6 X 1	FEX	FE	M6	(4)	1.53	1.5-1.78	8.74	8.72	7.72	9.74	3.3	0.95	7.1	6.5

- (1) In applications between the sheet thicknesses for your thread size, see last paragraph of installation data .
- (2) 2B Go Gauge may stop at barrel end but class 3A screw will pass thru with finger torque.
- (3) 6H Gauge may stop at barrel but 4h screw will pass thru with finger torque.
- (4) Not Applicable.

# EDM<sup>TM</sup> MINIATURE SELF-CLINCHING FASTENERS



TYPES EDM-U, EDM-UL, EDM-FE, EDM-FEO,  
EDM-FEX, EDM-FEOX

## MATERIAL & FINISH SPECIFICATIONS

Material	Code
300 Series Stainless Steel	U/UL
	FE/FEO
	FEO/FEOX

1. Specifications subject to change without notice.
2. Available On Custom Make Specification.

## INSTALLATION

1. Punch or drill properly sized mounting hole in sheet. Do not perform any secondary operations such as deburring.
2. Place shank of fastener into mounting hole, preferably the punch side.
3. With punch and anvil surfaces parallel, apply squeezing force until knurled collar is flush with top of the sheet for sheets .060" / 1.5 mm thick and up, or until shank is flush with the bottom of the sheet for sheets .040" / 1 mm to .060" / 1.5 mm thick for type FE/FEO.

